



diagnostic radiology PLLC

902 S Bryant Ave Edmond, OK 73034

348-1900 Scheduling 348-5252 Fax 348-0423

X-Ray - Fluoroscopy - CT - QCT Bone Densitometry - Ultrasound - Digital Mammography

PATIENT NAME _____ DOB ____/____/____

DATE OF EXAM ____/____/____ TIME OF EXAM _____ AM / PM

EXAM REQUESTED _____

SYMPTOMS / DIAGNOSIS _____

REFERRING PHYSICIAN _____

SEND IMAGES WITH PATIENT IF SO, CD or FILM

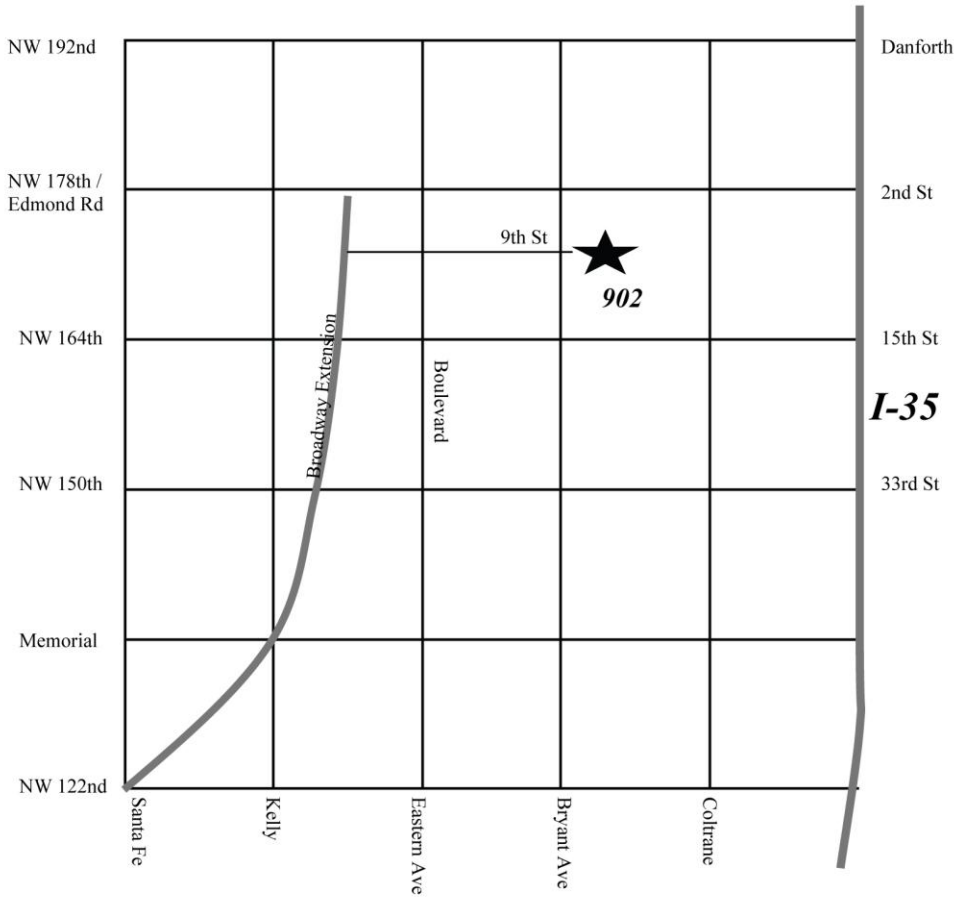

Diagnostic Radiology
902 S Bryant Ave
Edmond, OK 73034
405-348-1900

Diagnostic Radiology is located at the SE corner of 9th and Bryant at the entrance to Hafer Park.

Interactive map available at www.edmondradiology.com